

D. D. A

DWARKA PROJECT

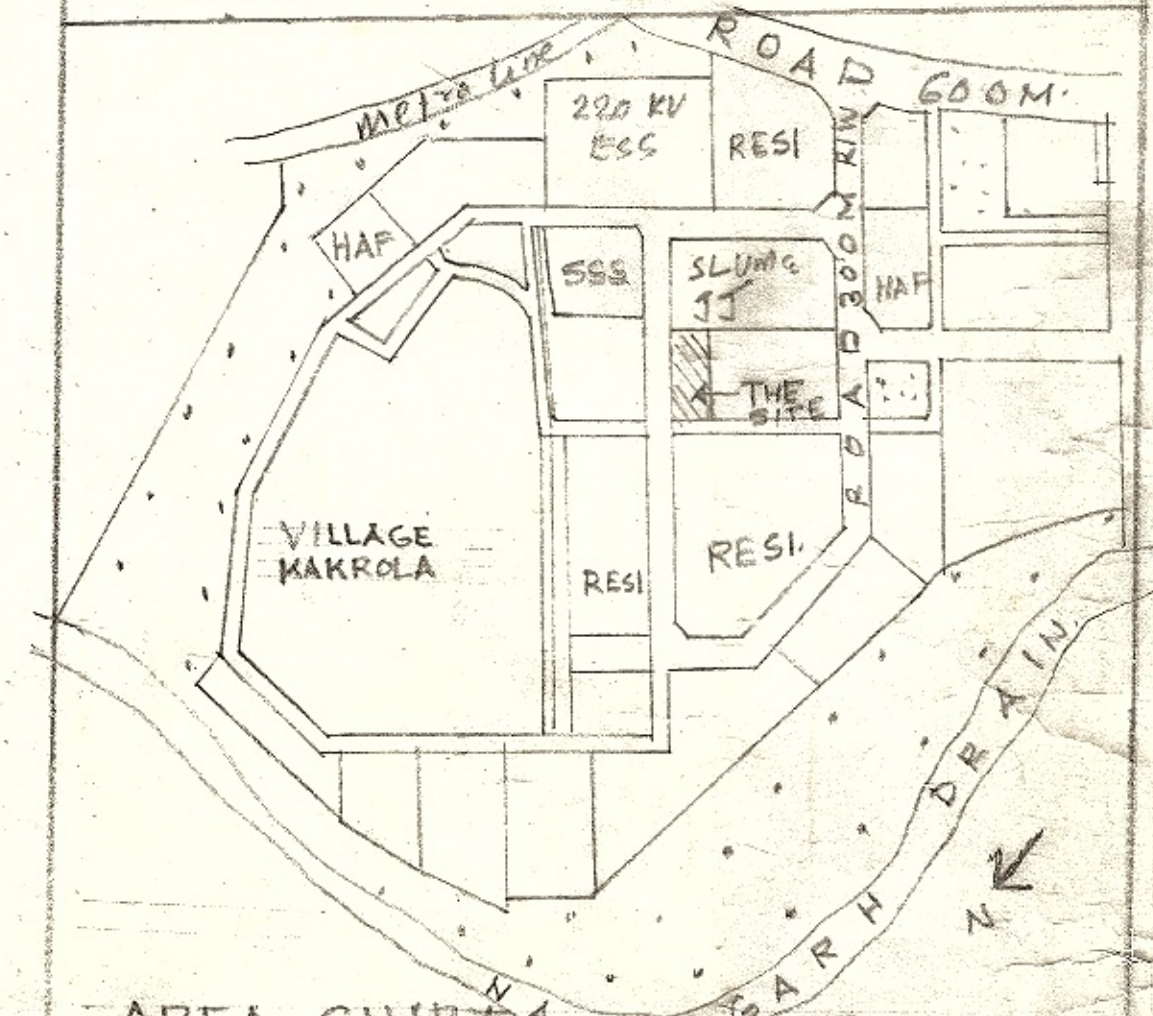

AREA CHART

SNO.	FACILITIES	AREA IN SQM	UNIT
1.	PRIMARY SCHOOL	2000.00	PLOT
2.	C.S.C	1130.00	SIZE
3.	O.C.F	800.00	AS PER
4.	DISPENSARY	970.00	MPD
5.	E.S.S - 2 NOS	160.00	2021
6.	CIRCULATION	1513.00	
TOTAL		6573.00	

TOTAL AREA OF HAF-B = 6573.00 SQM

THE APPROVAL OF THIS SCHEME BY THE 262nd SCREENING COMMITTEE MEETING HELD ON 18.10.08 VIDE ITEM NO 101.2008 HAS BEEN CERTIFIED BY THE DIRECTOR (PLG) DWK AND VERIFIED BY THE DDCARCH) CORDI.IMPW. ON 10.3.09

HOUSING AREA FACILITY - PKT-B SECTOR 16-B

SCALE: 1:1000		DRG. NO. DWK/SEC1 HAFB/53
REETA SEHGAL, PLG. ASSTT.	S. P. KAUR, PLG. ASSTT.	DATE Jan
N.R. ARAVIND, ASSTT. DIR.	S. DAS, JT. DIRECTOR	R.K. JAIN, DIRECTOR (PLG)
DELHI DEVELOPMENT AUTHORITY		

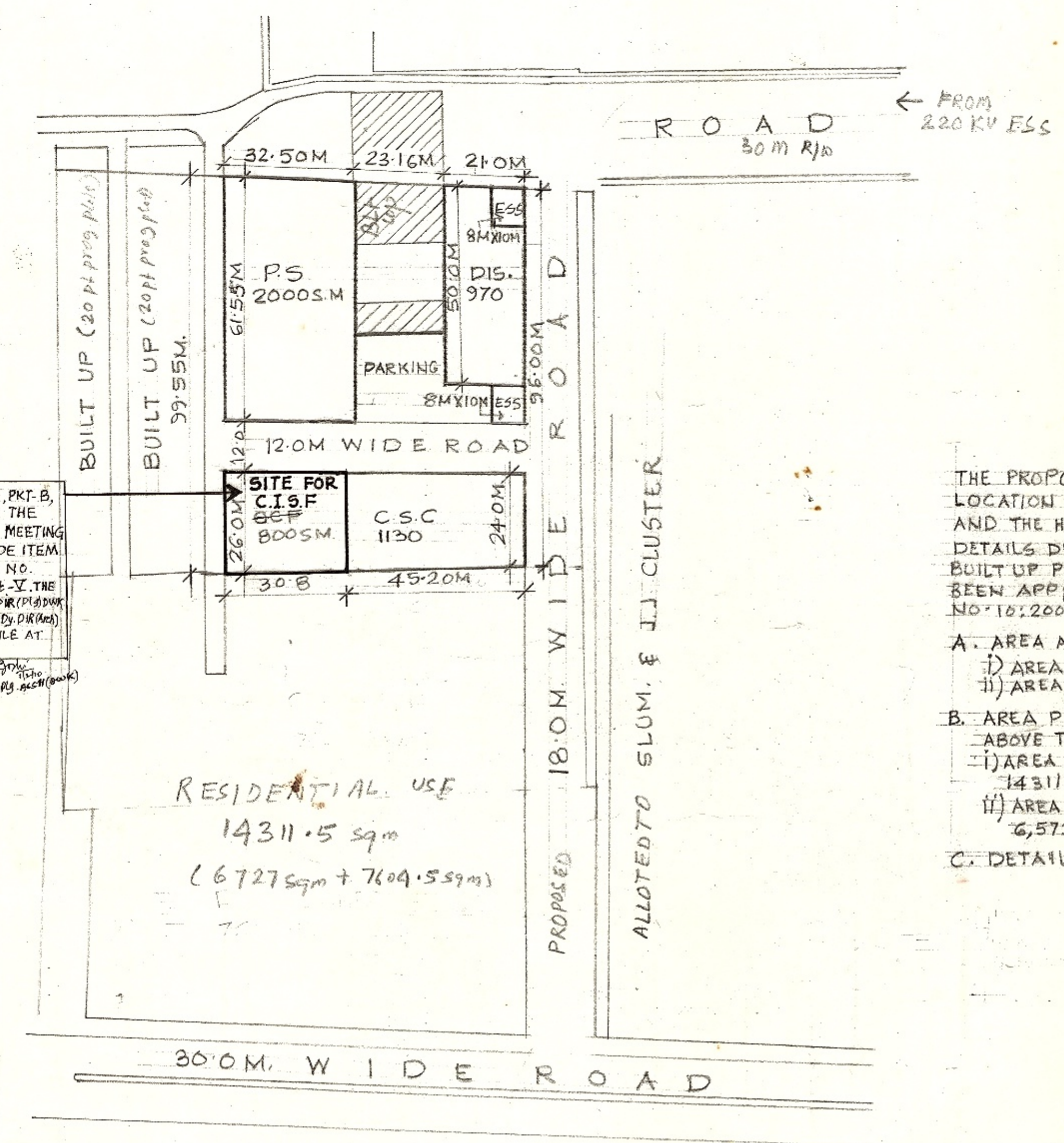

MODIFICATION IN HAF, PKT-B, Sec-16B, APPROVED IN THE 284th SCREENING COMM. MEETING HELD ON 26.10.09 VIDE ITEM NO 144.2009 IN FILE NO. F4(16)/2007/PLG/DWK/PK-B. THE SAME WAS CERTIFIED BY DIR (PLG) DWK ON DT. 10.2.09 & VERIFIED BY Dy. DIR (M&C) COMD. ON DT. 18.1.10 IN THIS FILE AT P-101M.

THE PROPOSED MODIFICATION/SWAPPING LOCATION OF THE RESIDENTIAL POCKET AND THE HAF POCKET-B IS PER FOLLOWING DETAILS DUE TO EXISTING 20 POINT PROGRAMS BUILT UP PLOTS WHICH IS AS FALLOW HAS BEEN APPROVED BY S.C. NO 262 - VIDE ITEM NO 101.2008 HELD ON 18.1.2008

A. AREA AS PER APPROVED SECTOR PLAN (26,400 SQM)

- i) AREA OF RESIDENTIAL POCKET - 18,300 SQM
- ii) AREA OF FACILITY POCKET - 8,100 SQM

B. AREA PROPOSED AFTER SWAPPING THE ABOVE TWO SITES (20884.50 SQM)

- i) AREA PROPOSED FOR RESIDENTIAL USE - 14311.50 SQM
- ii) AREA PROPOSED FOR HAF POCKET - 6,573.00 SQM

C. DETAILS OF PROPOSED HAF POCKET-B

RESIDENTIAL USE
14311.5 sqm
(6727 sqm + 7604.5 sqm)

32.50
23.16
21.00
76.66

26
12
61.55
99.55